



polytec

ARCHITECTURAL range

imi-beton
fabrication

Create your look

imi-beton Board

Corner Formation

There is a special edge set for creating corners – composing of mineral Filler, Covering Colour and Patina.



Requires no special tools.

Filler kit.

Edge Fabrication

- Sand MDF edges, then clean.
- Apply outer coat of paint with foam paint roller.
- Thinly apply Filler with foam paint roller, let it dry, and sand.
- Seal with matt varnish (not supplied).
- Wipe with Patina.

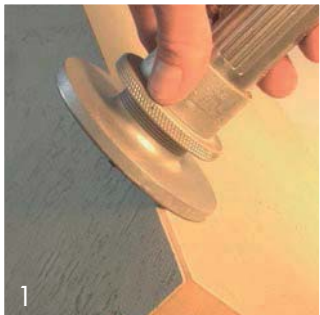

1 Cut the boards mitre and glue them together.



2 After gluing, mill cut the edges with a planer or router.

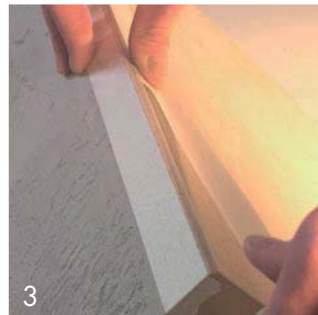

3 Edge surface has to be secured by a masking tape.

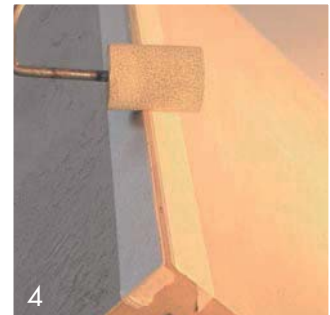

4 Thinly apply the coating mass. Drying time should be at least 4-5 hours.



5 Take away the masking tape and fine sand.

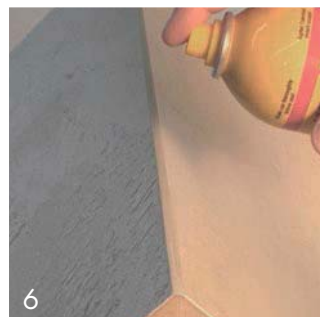

6 Seal with a matt varnish (not supplied)



7 In order to achieve the original concrete character wipe the varnished and processed area with the Patina for final fabrication.



polytec

ARCHITECTURAL range

imi-beton
fabrication

Create your look

imi-beton Flex

Edge Fabrication

- Sand MDF edges, then clean.
- Apply outer coat of paint with foam paint roller or brush
- Seal twice with matt varnish.

Corner Formation

- Cut boards to mitre and glue together.
- After gluing, simply chamfer the corners slightly with a sanding block.
- In certain circumstances tape off the chamfer with masking tape.
- Apply **imi-beton** Outer Coating / Covering Colour with roller or brush.
- Let it dry.
- Seal twice with matte varnish.



Rust Outer Coating



Anthracite Covering Colour



Grey Covering Colour

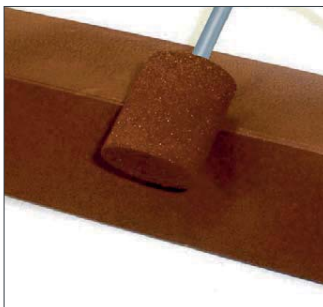

Requires no special tools.



polytec offer an express sample service.

Visit www.polytec.com.au to order your free sample.

polytec

www.polytec.com.au

p 1300 300 547 e sales@polytec.com.au