

PARTITIONING SYSTEMS

Full Height – Overhead Braced – Pedestal Mounted

Installation Guide

Requirements

A 'check' measure must be completed before ordering systems to ensure correct, accurate installation.

Pre-conditioning of **polytec's** Partitioning Systems is recommended. Expose the product to their final environment for as many days as possible before installation, as changes in relative humidity can mean dimensional changes in the panels. The recommend minimum period is five days.

Processing

polytec's Partitioning Systems are supplied with panels and components accurately cut and almost completely pre-drilled. In the event further processing is required, **polytec's** Partitioning Systems can be cut, drilled and machined using standard woodworking tools. Cut edges can be lightly sanded. In order to maintain the black core of the Partitioning Systems, an oil such as linseed oil will protect and enhance the edges.

Installation

Installation instructions are included with each **polytec** Partitioning System supplied.

Ensure all windows are positioned in between cubicles and make sure they do not interfere with any wall fixings. The door should be able to swing freely.

Partitions should line up with floor and wall tiles, along with avoiding obstruction to light fittings and air conditioning ducts. Measure partitions accurately to ensure they fall within these points, while also checking walls for plumbing, and floor level.

Fixing

polytec Partitioning Systems are supplied with all hardware and extrusions (excluding screws required to anchor Partition to walls, floor or ceiling.).

polytec supply depth stop drill-bits tailored for the installation procedure. The bits are designed to facilitate all pre-drilling measures for the 13mm Compact Laminate material.

The supplied drill-bit is intended for use in the Compact laminate only.

Utilizing the supplied drill-bit to bore holes within the channel and Compact laminate simultaneously, will result in shallow pilot holes and can lead to perforation of the rear face.

Care should be taken not to pre-drill holes through to the other side of the panel, particularly with 13mm Compact laminate.

When drilling the pilot hole, please limit pressure on the drill-bit as excessive pressure can cause the far side of the panel to push out.

Storage & Handling

Storage area should be an enclosed space, protected from moisture and heat, away from direct sunlight. When moving product, ensure care is taken to avoid scratching of the decorative surface. Ensure the pooling of water on the surface cannot occur and allow sufficient ventilation and drainage in enclosed spaces.

All packs should be evenly supported at each end, at intervals of no more than 600mm wide. All supports should be vertically aligned where packs are stacked. Minimise leaning panels against walls vertically to avoid bowing.

Care & Maintenance

To maintain the antibacterial effectiveness of **polytec's** Partitioning Systems, the surface should be kept clean. Provided that good hygiene practices are followed; the antibacterial certified surface will be sustained for the expected life of the product. It is recommended after general cleaning; the Compact laminate surface should be wiped down with isopropanol.

polytec's Compact laminate has been independently tested in accordance with industrial standard JISZ2801 test for antibacterial activity and efficacy.

Always ensure that you refer to the recommendations provided by the cleaning product manufacturer before use.

polytec

www.polytec.com.au

p 1300 300 547

PANEL FIXING

13mm Compact laminate panels are a wood-based product and as such, will be affected by moisture and humidity. Panels may expand in length by approximately 2.5mm/m, it is imperative that a sufficient void is left within the aluminium extrusion to allow minor movement.

A 4mm depth stop drill-bit is supplied for the pilot holes in the **Compact laminate only** and should not be used to drill any pilot holes in the aluminium extrusion. A 6mm diameter drill-bit should be used for the aluminium extrusion to allow for minor panel expansion.

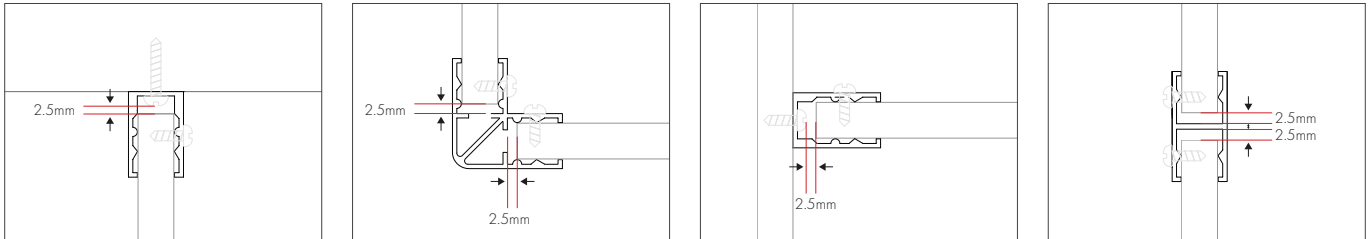

STEP 1

- Before you begin, review the installation plans and take note of the floor run, window, bulkheads or other objects that may interfere with the installation process.
- Ensure wall channels are set into position according to measurements, channels are set level and plumb.
- Screw the division and end nib channel to the rear and side walls.
Please note: screws are not supplied.

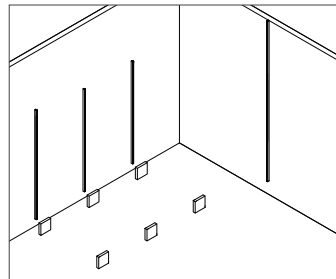

STEP 2

- Begin placing the divisional panels into the rear wall channels on leveling blocks.
- Do not screw the divisional channels in completely, as adjustments may be needed later to line up the doors and front panels.

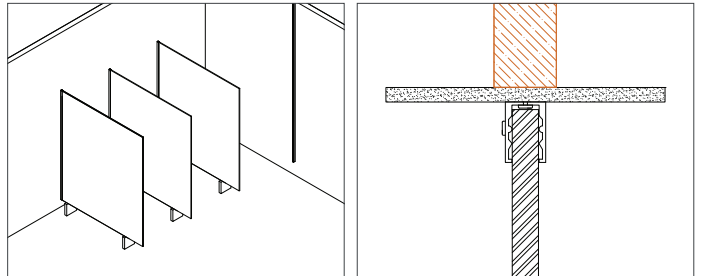

STEP 3

- Determine the position for the overhead brace and cut it to the desired length. Attached the overhead brace to roof, take note that a solid fixing above the ceiling to be installed prior by builder.
- If an external division is used, you can now install the corner channel also.

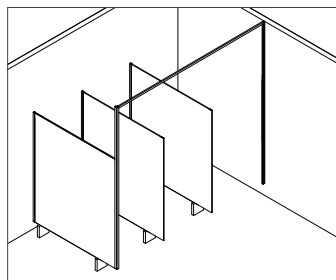

STEP 4

- a. Insert the nibs into the extrusions, and screw into the overhead rail.
- b. Place the infill cap between first frontal and end nib. If the system features a Modesty profile in conjunction with an Overhead/Ceiling Brace, the infill cap will need to be cut at 30 degrees to match the profile of the frontals/nibs.
- c. Pushing frontal hard against the insert, secure headrail to frontal. Be sure to allow two screws per frontal and repeat for remaining partitions.

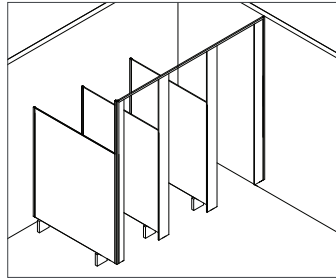
**STEP 5**

- a. Determine the leg position then fix plate to floor once it has been located. Leg can be removed via grub screw on side of base.
- b. Refit leg to base and fix to the partition.

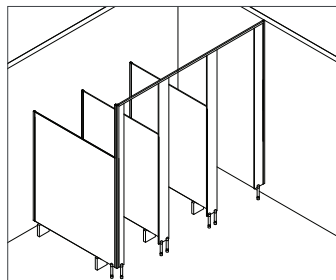
**STEP 6**

- a. Fix the hinges and hang doors. Using three screws, secure all divisional panels to the rear channel. Adjust the spring pressure in the bottom hinge until the door operates as desired. **Note:** When installing the lock mechanisms, please ensure the correct spline/screws are used. 13mm doors require the smallest spline/screws supplied.
- b. Install the indicator locks, bumpers, hook & handles.

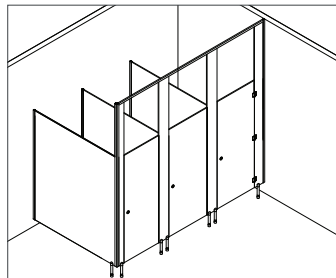

NOTE: Do not over tighten door lock screws as excessive force can damage the mechanism and prevent locks from functioning properly. The safest method is to hand tighten screws on all door locks, do not use a drill.