

# PARTITIONING SYSTEMS

## Unisex - Overhead Braced - Floor Mounted

### Installation Guide

#### Requirements

A 'check' measure must be completed before ordering systems to ensure correct, accurate installation.

Pre-conditioning of **polytec** Partitioning Systems is recommended. Expose the product to their final environment for as many days as possible before installation, as changes in relative humidity can mean dimensional changes in the panels. The recommended minimum period is five days.

#### Processing

**polytec** Partitioning Systems are supplied with panels and components accurately cut and almost completely pre-drilled. In the event further processing is required, **polytec's** Partitioning Systems can be cut, drilled and machined using standard woodworking tools. Cut edges can be lightly sanded. In order to maintain the black core of the Partitioning Systems, an oil such as linseed oil will protect and enhance the edges.

#### Installation

Installation instructions are included with each **polytec** Partitioning System supplied.

Ensure all windows are positioned in between cubicles and make sure they do not interfere with any wall fixings. The door should be able to swing freely.

Partitions should line up with floor and wall tiles, along with avoiding obstruction to light fittings and air conditioning ducts. Measure partitions accurately to ensure they fall within these points, while also checking walls for plumbing, and floor level.

#### Fixing

**polytec** Partitioning Systems are supplied with all hardware and extrusions (excluding screws required to anchor Partition to walls, floor or ceiling).

Correct pilot holes are essential to avoid splitting. They should be 2mm longer than the screw used and should be approximately 90% of the screw core diameter.

Care should be taken not to pre-drill holes through to the other side of the panel, particularly with 13mm Compact laminate.

When drilling the pilot hole, please limit pressure on the drillbit as excessive pressure can cause the far side of the panel to push out.

#### Storage & Handling

Storage area should be an enclosed space, protected from moisture and heat, away from direct sunlight. When moving product, ensure care is taken to avoid scratching of the decorative surface. Ensure the pooling of water on the surface cannot occur and allow sufficient ventilation and drainage in enclosed spaces.

All packs should be evenly supported at each end, at intervals of no more than 600mm wide. All supports should be vertically aligned where packs are stacked. Minimise leaning panels against walls vertically to avoid bowing.

#### Care & Maintenance

To maintain the antibacterial effectiveness of **polytec's** Partitioning Systems, the surface should be kept clean. Provided that good hygiene practices are followed; the antibacterial certified surface will be sustained for the expected life of the product. It is recommended after general cleaning; the Compact laminate surface should be wiped down with isopropanol.

**polytec's** Compact laminate has been independently tested in accordance with industrial standard JISZ2801 test for antibacterial activity and efficacy.

Always ensure that you refer to the recommendations provided by the cleaning product manufacturer before use.

**polytec**

[www.polytec.com.au](http://www.polytec.com.au)

p 1300 300 547

**STEP 1**

- Before you begin, review the installation plans and take note of the floor run, window, bulkheads or other objects that may interfere with the installation process.
- Ensure wall channels are set into position according to measurements, channels are set level and plumb.
- Screw the division and end nib channel to the rear and side walls. **Please note:** polytec do not supply the screws.

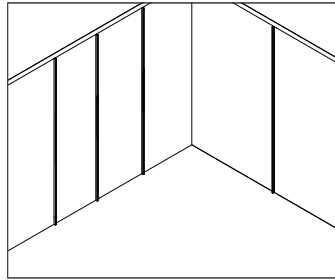
**STEP 2**

- Position and screw the u-channel into the ceiling, take note that a solid fixing above the ceiling line should have been installed by the builder. **Please note:** polytec do not supply the screws.

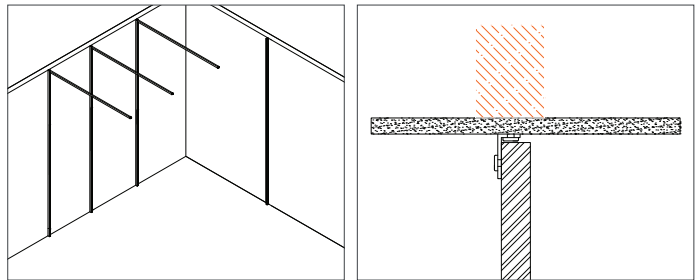
**STEP 3**

- Position and screw the l-channel into the floor.
- You can now install the division panels and confirm the positioning is correct.

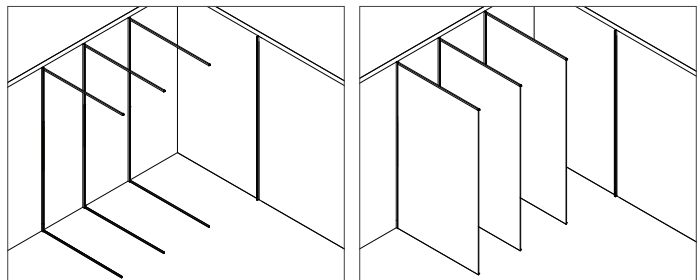
**STEP 4**

- Determine the position for the overhead brace and cut it to the desired length. Attach the overhead brace to roof, take note that a solid fixing above the ceiling line should have been installed by the builder. **Please note:** polytec do not supply the screws.
- If an external division is used, you can now install the corner channel also.

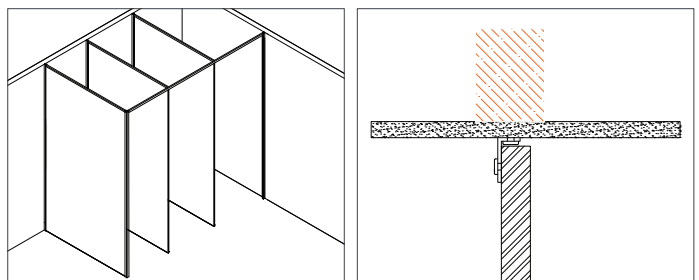
**STEP 5**

- Determine the position for the l-channel at the front of each internal division. Attach the l-channel to the floor. **Please note:** polytec do not supply the screws.

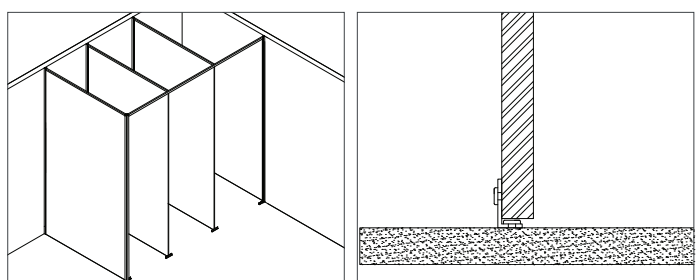

**STEP 6**

- a. As per plan, fit wall channel to frontal.
- b. Fit the frontal nib to the divisional partitions and fix.
- c. Position nib into overhead rail, at this stage only screw head rail to nib.
- d. Place the infill cap between first frontal and end nib.
- e. Pushing frontal hard against the insert, secure headrail to frontal. Be sure to allow two screws per frontal and repeat for remaining partitions.

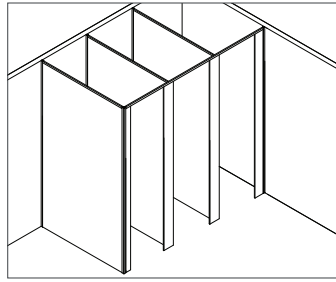
**STEP 7**

- a. Fix the hinges and hang doors. Using three screws, secure all divisional panels to the rear channel. Adjust the spring pressure in the bottom hinge until the door operates as desired.
- b. Install the indicator locks, bumpers, hook & handles.

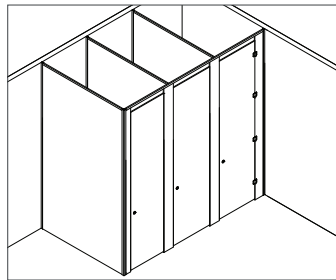

**NOTE:** Do not over tighten door lock screws as excessive force can damage the mechanism and prevent locks from functioning properly. The safest method is to hand tighten screws on all door locks, do not use a drill.